

VICINITY MAP FOR  
**BARBER MILL ESTATES**

A PARCEL OF LAND LOCATED IN THE SE 1/4 OF SECTION 29,  
T.3N., R.3E., B.M., CITY OF BOISE, ADA COUNTY, IDAHO  
2013

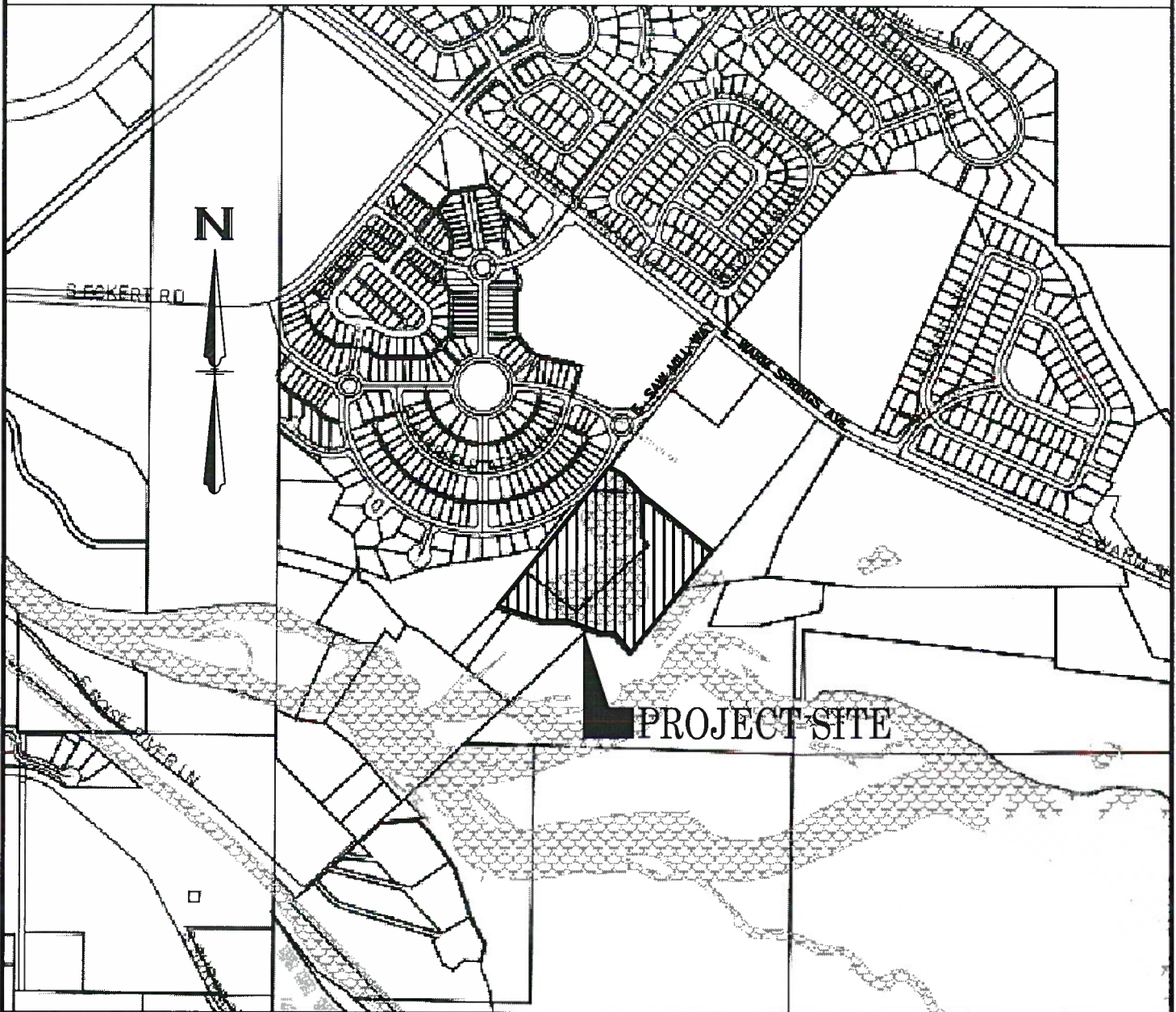

**ROCK SOLID CIVIL**

Civil Engineering and Land Development Consulting

181 East 50th Street, Garden City, ID 83714

Office Phone: 208.342.3277

[www.rocksolidcivil.com](http://www.rocksolidcivil.com)

SUB

0017