



R3 RENDERING: LOOKING EAST ALONG STATE STREET



R4 RENDERING: LOOKING WEST ALONG STATE STREET



R2 RENDERING: LOOKING UP BOULEVARD FROM STATE STREET



R1 RENDERING: LOOKING DOWN BOULEVARD TOWARD STATE STREET

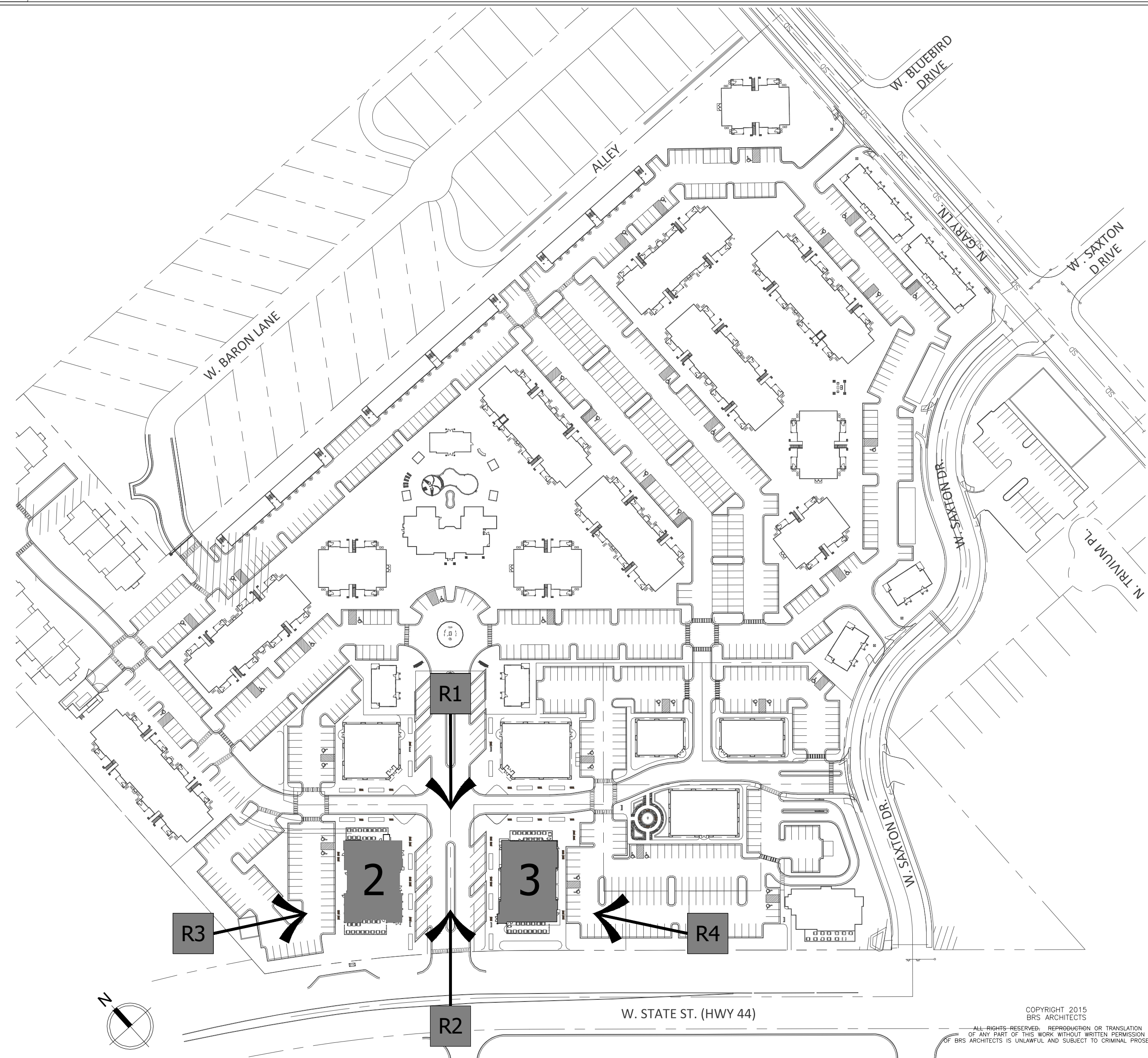

| | |
|---------------|--|
| CITY APPROVAL | |
| | |
| | |
| | |
| | |

| | | |
|-----|-----------|------|
| NO. | REVISIONS | DATE |
| | | |
| | | |
| | | |

| | | |
|-----|-----------|------|
| NO. | REVISIONS | DATE |
| | | |
| | | |
| | | |

1010 S. ALLANTE PL.
SUITE 100
BOISE, IDAHO 83709
(208) 336-8370
FAX (208) 336-8380

BRS
ARCHITECTS

PROPOSED DEVELOPMENT FOR:

NORTH POINTE RETAIL

BUILDINGS 2 + 3

BOISE, IDAHO 83714

W. STATE STREET

| | |
|---------|------------|
| DRAWN | RR |
| DATE | 04-07-2015 |
| CHECKED | TK |
| JOB NO. | 15028 |
| SHEET | BC.2 |