

Levie Architectural Group  
an Idaho PLLC  
17711 Karen Drive, Encino, CA  
91316

p 818 . 996 . 3507  
f 818 . 273 . 1080  
email : LeviaArch@ms.com

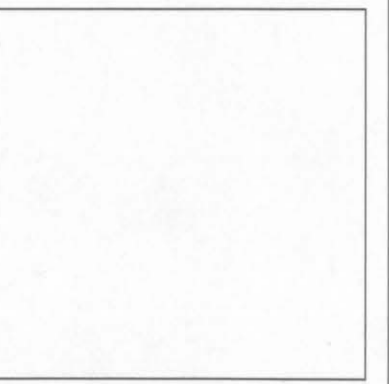

Project Status  
Project Status

No.	Description	Date

Client: **Applicant Glenn Levie**  
Project Address: **1005 W Royal Blvd  
Boise, ID**  
Project Name: **Royal Cubes Residential / Office**

Fourth Level  
Detail

Project number Project Number  
Date Issue Date  
Drawn by Author  
Checked by Checker

**DR-6**

Scale 3/32" = 1'-0"  
Plot Date 6/6/2011 1:45:00 PM

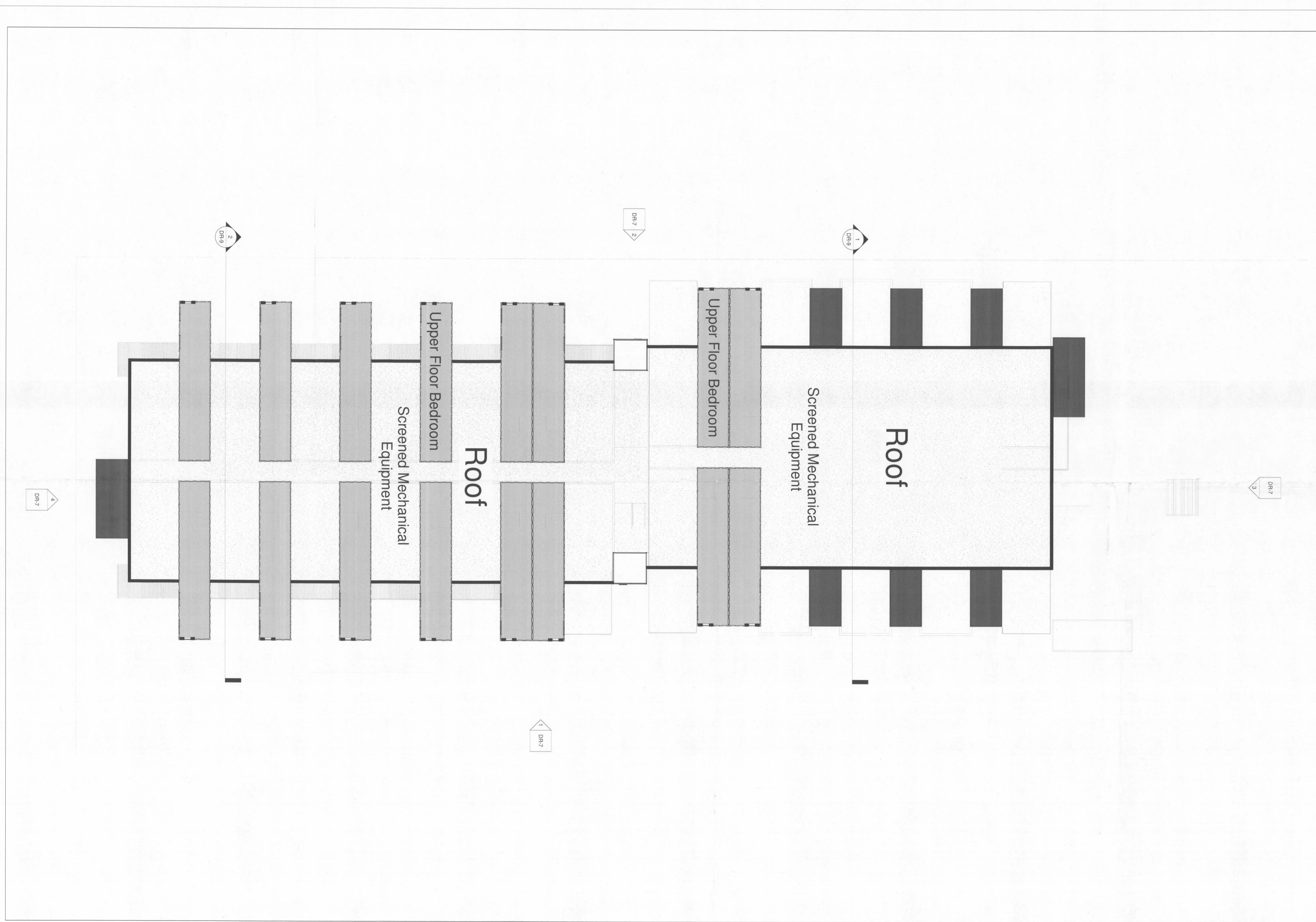

RECEIVED

JUN 07 2011  
DEVELOPMENT  
SERVICES  
**DRH11-00133**