

Levie Architectural Group
an Idaho PLLC
17711 Karen Drive, Encino, CA
91316
p 818.996.3307
f 818.273.1060
email: LeviaArch@ms.com

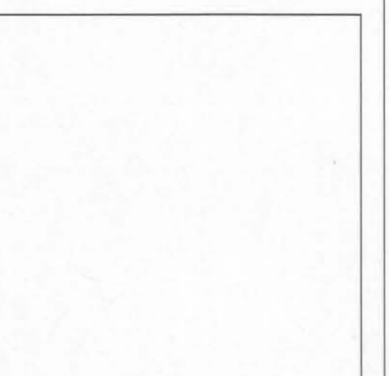

Project Status		
No.	Description	Date

Client: **Applicant Glenn Levie**
Project Address: **1005 W Royal Blvd Boise, ID**
Project Name: **Royal Cubes Residential / Office**

Ground Level / Landscape Lighting

Project number	Project Number
Date	Issue Date
Drawn by	Author
Checked by	Checker

DR-2
Scale 1/16" = 1'-0"
Plot Date 6/6/2011 1:44:34 PM

All Ground Cover / Grasses to be Best Practices Water Conservation Planting Materials. Design Build Irrigation as Necessary for Plant Species

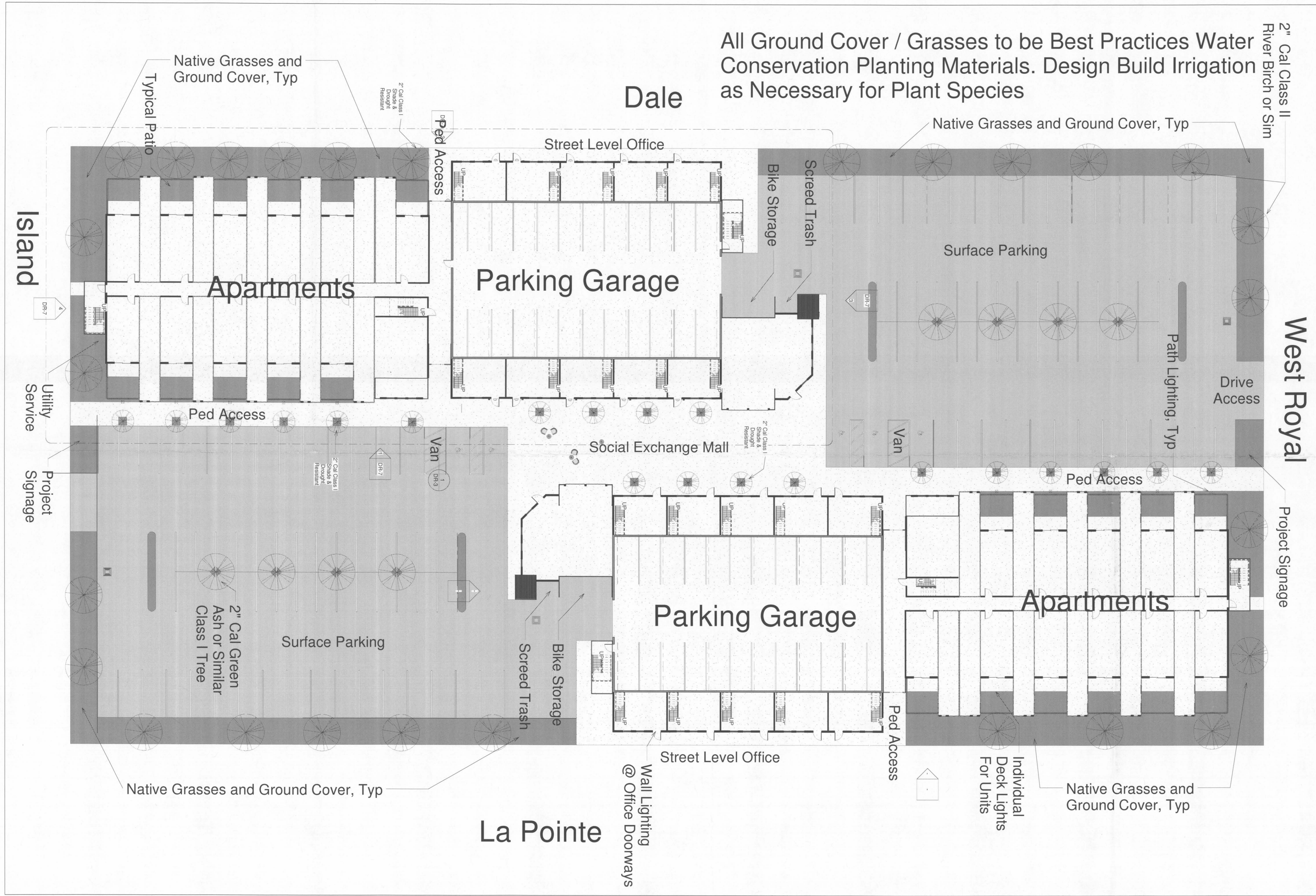

DRH11-00133