



erated ARCHITECTS, PA
 425 main street, suite 202, boise, idaho 83702
 (208) 331-9811 fax 331-9853 e-mail: info@eratedarch.com



This document is the property of **erated ARCHITECTS** and is protected by U.S. and international laws. Use, reproduction, or modification of this document without first obtaining the written permission of **erated architects** is prohibited. This document may not be used in any unauthorized manner. © 2012

capitol + front st.
 300 s. capitol blvd.
 boise, idaho 83702

revision:

project: 120903
 date: 11.13.12
 drawn: alm
 checked: ae

design review

site plan

a1.11

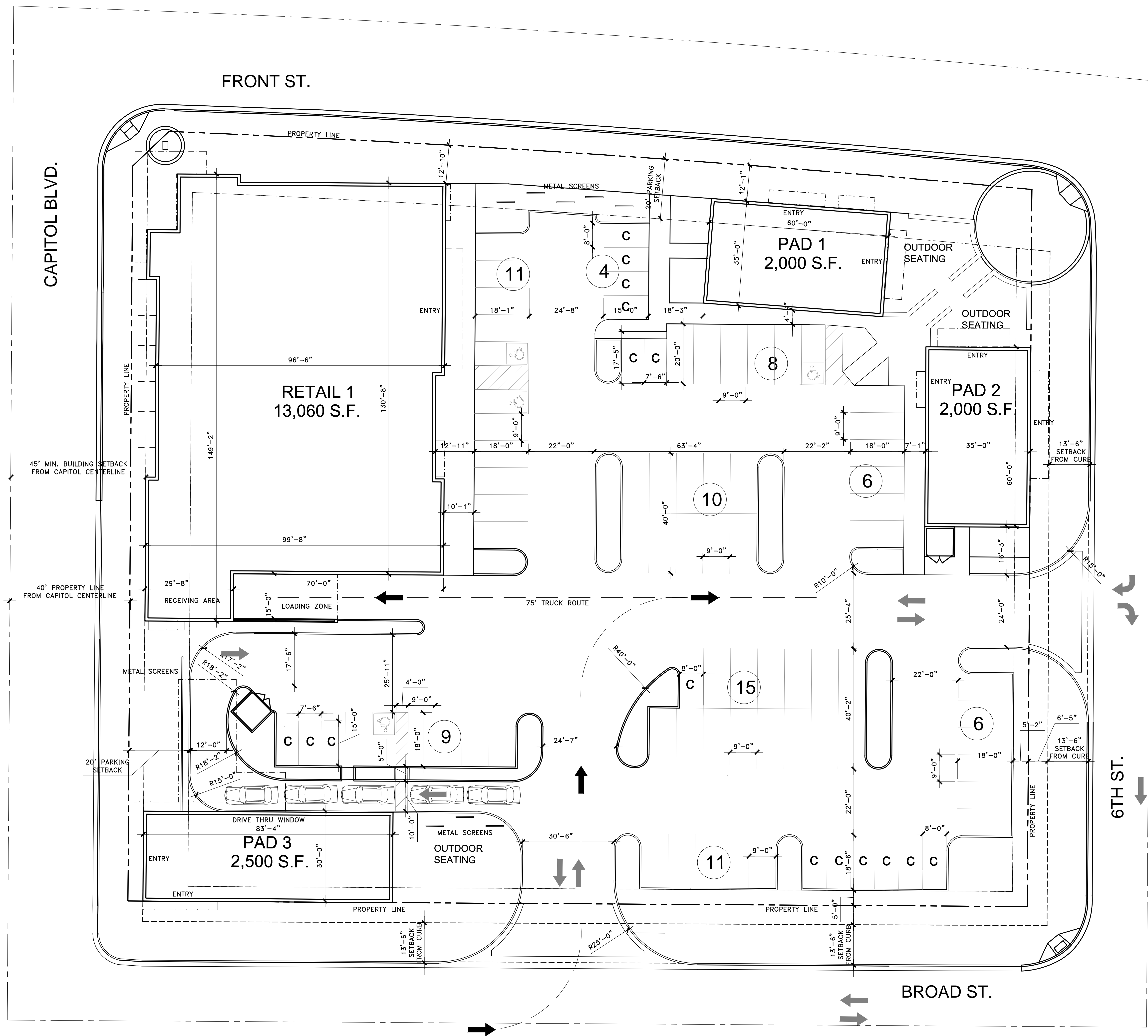

SITE DATA	
TOTAL SITE AREA:	1.72 Acres 74,827.1 S.F.
ZONING:	C-5DDC
BUILDING:	AREA
RETAIL 1	13,060 S.F.
PAD 1	2,000 S.F.
PAD 2	2,000 S.F.
PAD 3	2,500 S.F.
TOTAL:	19,560 S.F.
PARKING:	REQUIRED SHOWN
REGULAR	80 80
ADA	4 4
COMPACT	40X TOTAL MAX 16
TOTAL:	0 80
0 SQ.FT. LANDSCAPING REQUIRED 6,943 SQ.FT. LANDSCAPING SHOWN	

PROJECT NOTES:
 This conceptual site plan is for preliminary planning purposes only. Site specific information such as legal boundary, existing conditions, zoning, parking, curb cuts, traffic signals and landscape requirements must be verified before relying on same.

capitol blvd. + front st. site plan
 1/16"=1'-0"