

W. FRONT ST.

**HAWKINS COMPANIES**  
COMMERCIAL DEVELOPERS  
855 BROAD STREET, SUITE 300 BOISE, ID. 83702 (T) 208 376 8522 (F) 208 376 8523

**South**  
LANDSCAPE ARCHITECTURE, P.C.  
2002 S. VISTA AVE.  
BOISE, IDAHO 83705  
(208) 342-2999  
sla@elaboise.com

**PRELIMINARY**  
NOT FOR CONSTRUCTION PURPOSES

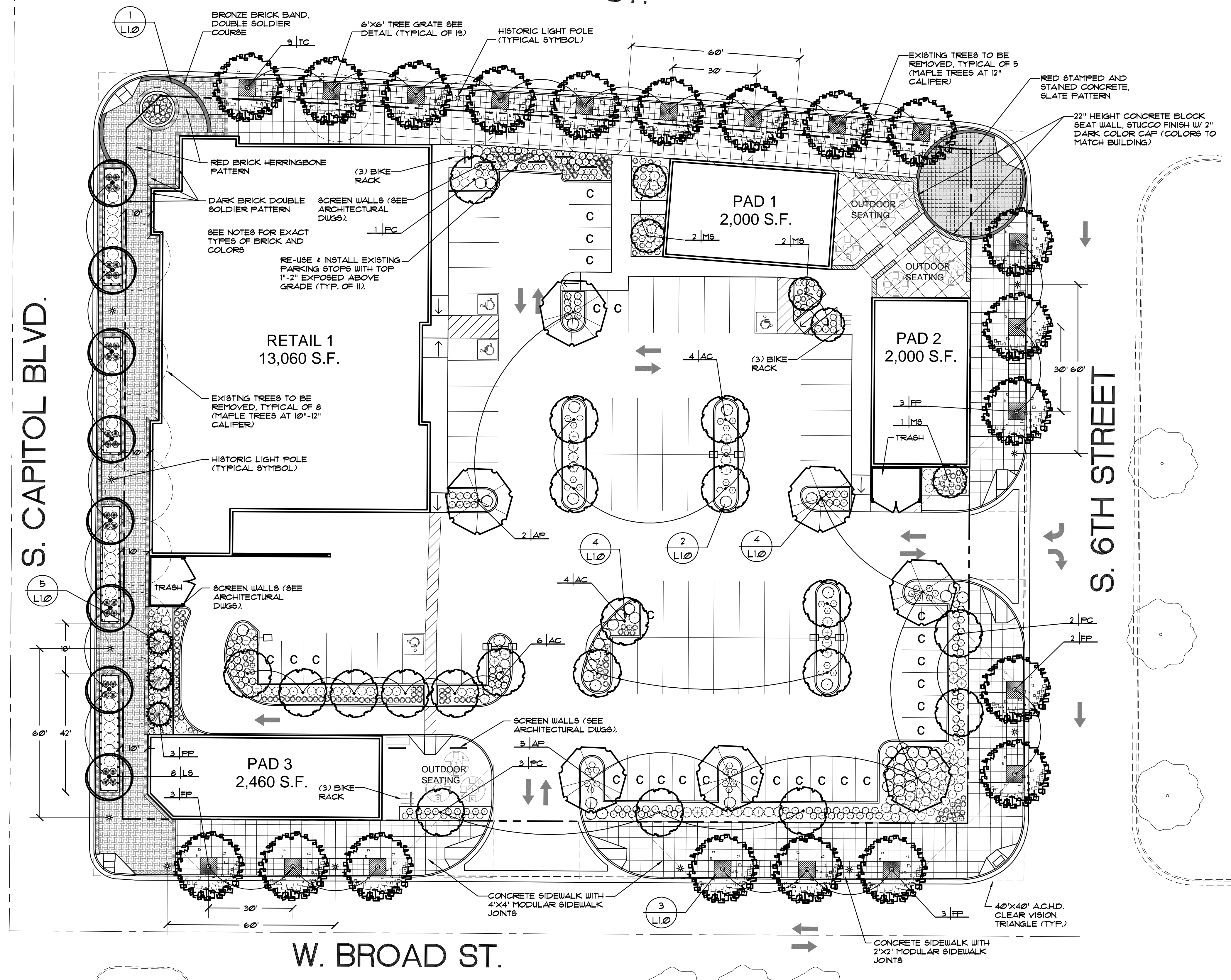
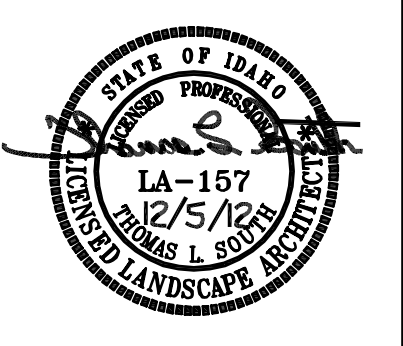

**PLANT SCHEDULE** (NOTE: ALL TREES TO BE GRADE #1)

QTY.	KEY	BOTANICAL NAME COMMON NAME	PLANTING SIZE	MATURE SIZE	CLASS
<b>TREES</b>					
14	AC	Acer platanoides 'Columnar' Columnar Norway Maple	2" B4B	25' hgt. 12' wide	I
1	AP	Acer platanoides 'Columnar Broad' Parkway Maple	2" B4B	35' hgt. 25' wide	II
6	PC	Fyrus calleryana 'Capital' Capital Flowering Pear	2" B4B	25' hgt. 12' wide	I
5	M6	Malus 'Red Barron' Red Barron Crabapple	2" B4B	18' hgt. 8' wide	I
8	L6	Liquidambar styraciflua 'Glydesform' Emerald Sentinel Sweetgum	2.5" B4B	25' hgt. 12' wide	I
11	FP	Fraxinus pennsylvanica 'Summit' Summit Ash	2.5" B4B	35' hgt. 25' wide	II
9	TC	Tilia americana 'Boulevard' Boulevard Linden	2.5" B4B	40' hgt. 25' wide	II
3	PP	Picea pungens 'Iseli Foxtail' Iseli Foxtail Spruce	3-4" hgt. B4B	10' hgt. 7' wide	Conifer
TOTAL TREES: 63 TOTAL TREE TYPES: 8					
<b>KEY - SHRUBS</b>					
○		Berberis thunbergii 'Crimson Pygmy' Crimson Pygmy Japanese Barberry	2 Gal.	3' hgt. x 3' wide	
○		Juniperus horizontalis 'Blue Chip' Blue Chip Juniper	2 Gal.	6" hgt. x 4' wide	
○		Rosa x Nostrana 'Pink Shrub Rose' Pink Shrub Rose	2 Gal.	3' hgt. x 4' wide	
○		Spiraea japonica 'Neon Flash' Neon Flash Spirea	2 Gal.	2' hgt. x 3' wide	
Note: Pink Shrub Rose shall match in kind the existing variety located adjacent to the property on the west side of Capitol Blvd. (Contact Boise City Forester).					
<b>GROUND COVERS/ GRASSES/ PERENNIALS</b>					
○		Calamagrostis x acutiflora 'Overdam' Overdam Feather Reed Grass	2 Gal.	3' hgt. x 3' wide	
○		Festuca ovina glauca 'Elijah' Elijah Blue Fescue	1 Gal. # 24" O.C.	18" hgt. x 18" wide	
○		Hemerocallis x 'Stella De Oro' Stella De Oro Daylily	2 Gal.	18" hgt. x 2' wide	
○		Lavandula angustifolia 'Trumbelina Leigh' Trumbelina English Lavender	1 Gal.	12" hgt. 12" wide	
○		Permatum slosseroides 'Little Bunny' Little Bunny Dwarf Fountain Grass	2 Gal.	2' hgt. x 25" wide	
○		Sedum x 'Brilliant' Brilliant Stonecrop	1 Gal. # 24" O.C.	18" hgt. x 18" wide	
○		Sedum x 'Blue' Blue Sedum	1 Gal. # 24" O.C.	18" hgt. x 18" wide	
○		Vincetoxicum 'Boules' Boules Common Periwinkle	4" Pots # 24" O.C.	6" hgt. x 2' wide	
○		Hedera helix 'Baltica' Baltic Ivy	1 Gal. # 24" O.C.	6" hgt. x 2' wide	

(NOTE: Plant material quantities are provided for convenience only and may not be accurate.)

**LANDSCAPE NOTES**

- See Specifications.
- All plant material shall conform to the American Nurseryman Standards for type and size shown.
- All landscape plantings and tree wells shall have an organic mulch UNLESS OTHERWISE NOTED ON THE DRAWING. Place # 3" minimum depth install per manufacturer's recommendations.
- All planting beds shall have 12" of topsoil at a minimum.
- Contractor shall respect any and all local utility setbacks and adjust planting as necessary in the field.
- Trim lower branches of proposed trees to preserve sight lines (per ACHD requirements).
- Contractor shall verify all plant schedule quantities on the plans, quantities are for convenience only.
- Contractor shall respect any and all CCDC and the City of Boise requirements and details.
- Contractor shall verify all underground site utilities before any work continues and follow all local, state, and federal laws.
- All landscape areas to be irrigated with a state of the art automatic underground irrigation system.
- NOTE: All street trees need to be approved or a recommendation will be provided by the Boise City Forester.

**SITE INFORMATION**

- Capitol Boulevard is classified as "Type 6 - Capitol Blvd." in the CCDC Downtown Boise Streetscape Standards 4 Specifications.
- Front Street, Broad Street and 6th Street are classified as "Type 3 - Urban Concrete" in the CCDC Downtown Boise Streetscape Standards 4 Specifications.
- Brick pavers shall be 2-3/4"x8" by Endicott Clay products (or approved equal) Dark Brick-Manganese Ironpot - Area at the base of buildings, and finishing zone.
- Red Brick-No. 46 Medium Ironpot Blend - Areas in the pedestrian zone.
- Historic Street lights are 60" O.C. and shall be located and approved by CCDC and The City of Boise Design Review.
- Locations of site furnishing along all street frontages, including benches, trash receptacles, bike racks, and moveable planters shall be coordinated with CCDC and The City of Boise Design Review for locations and quantities.

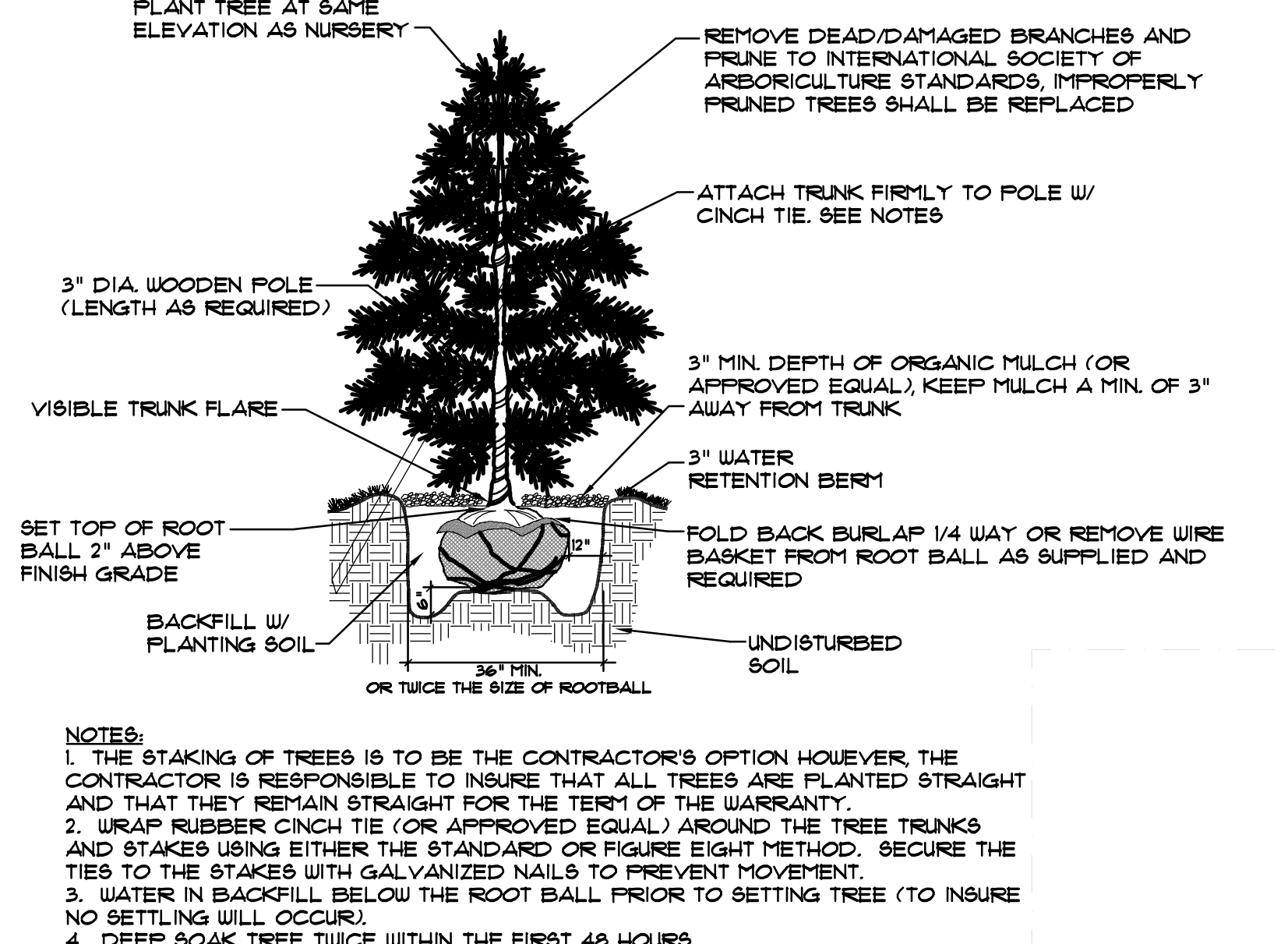
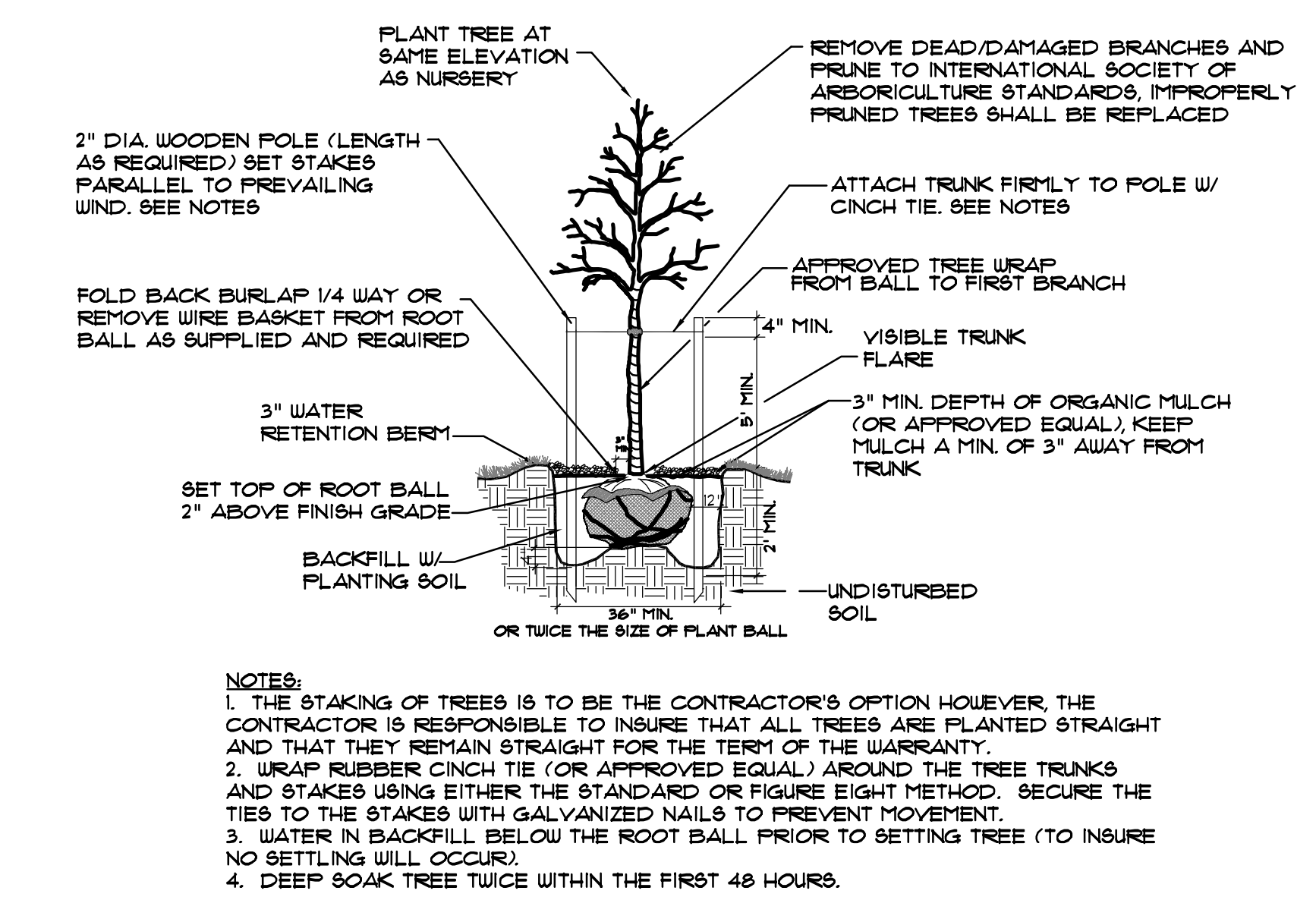
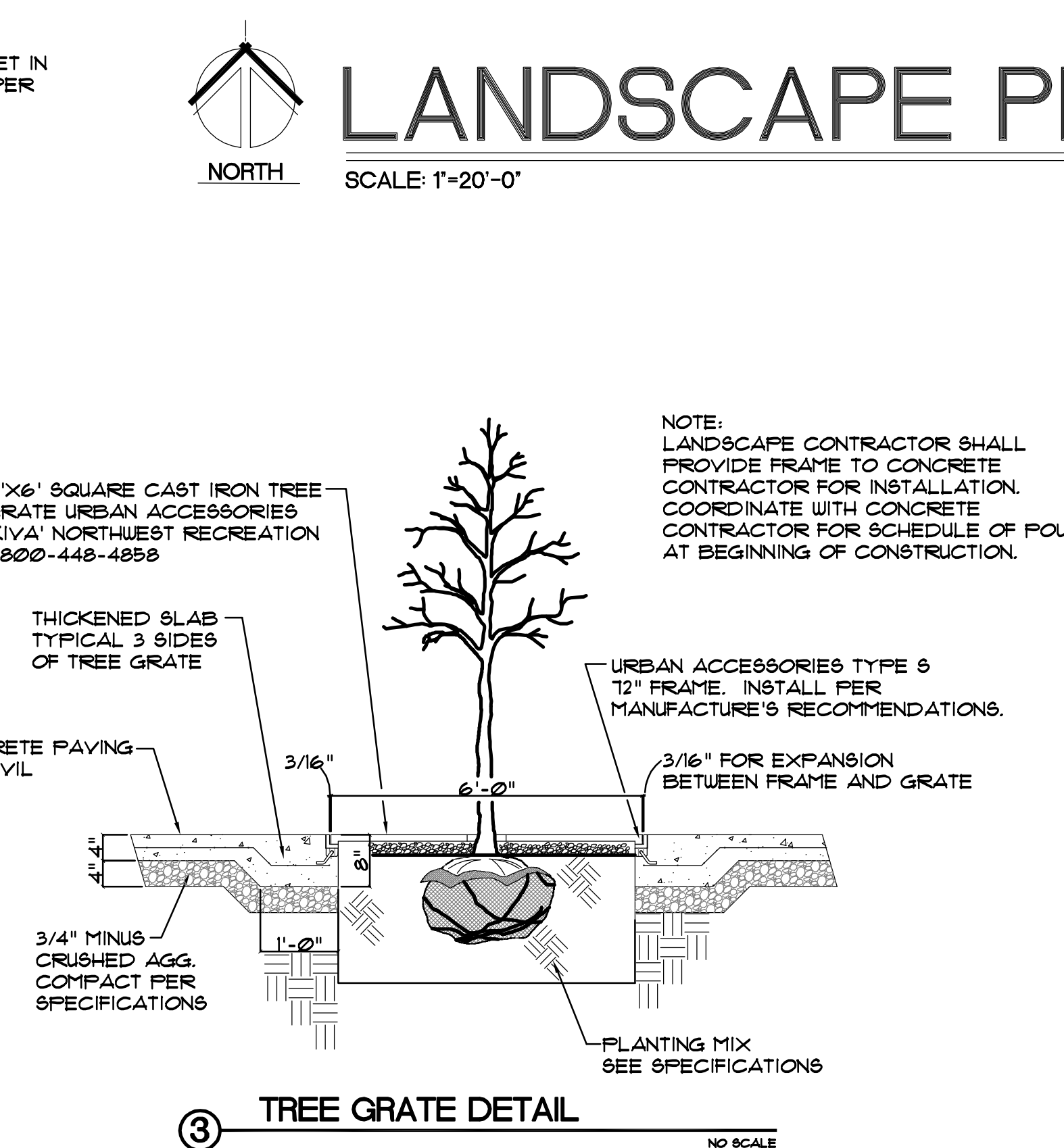
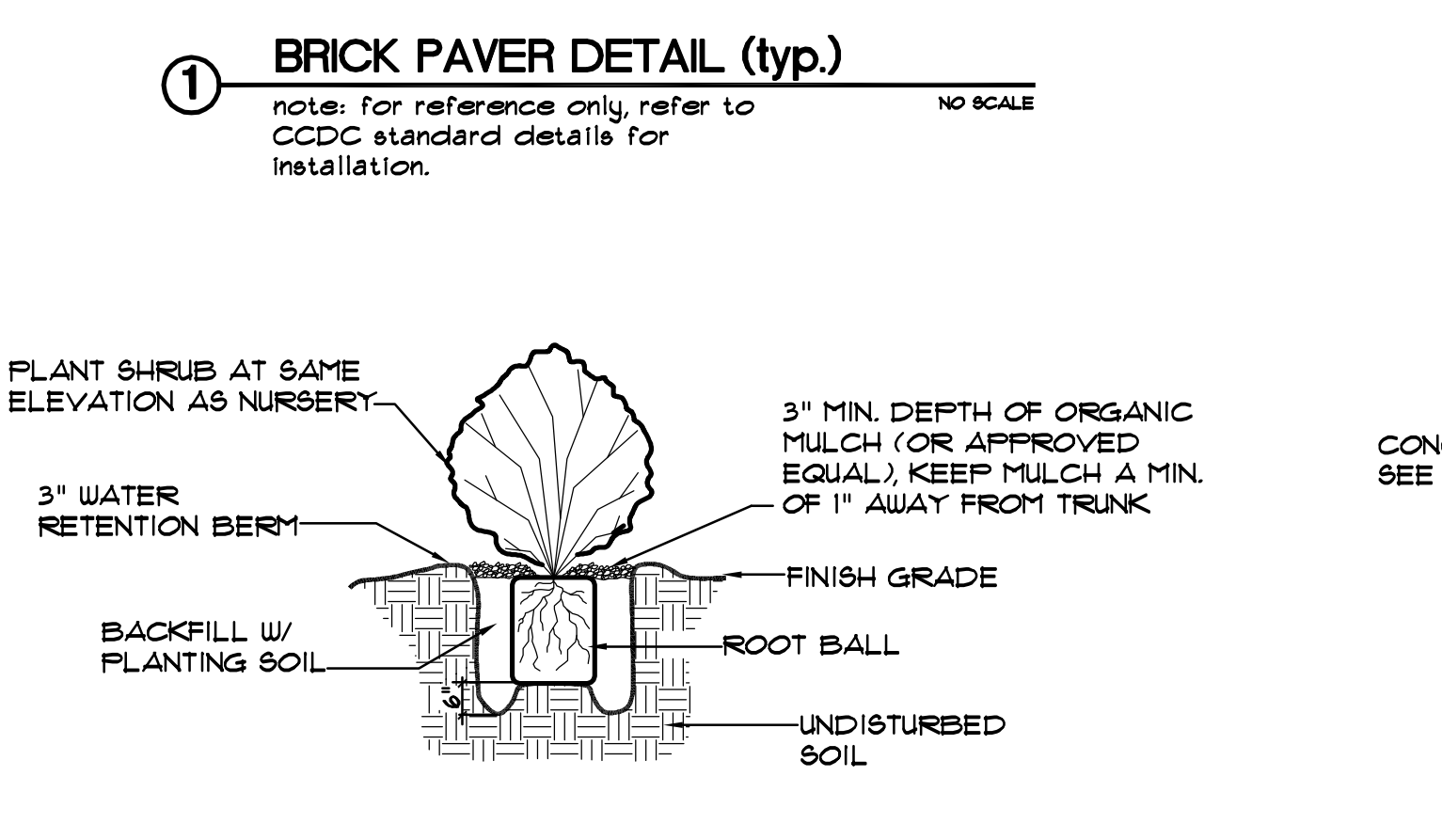
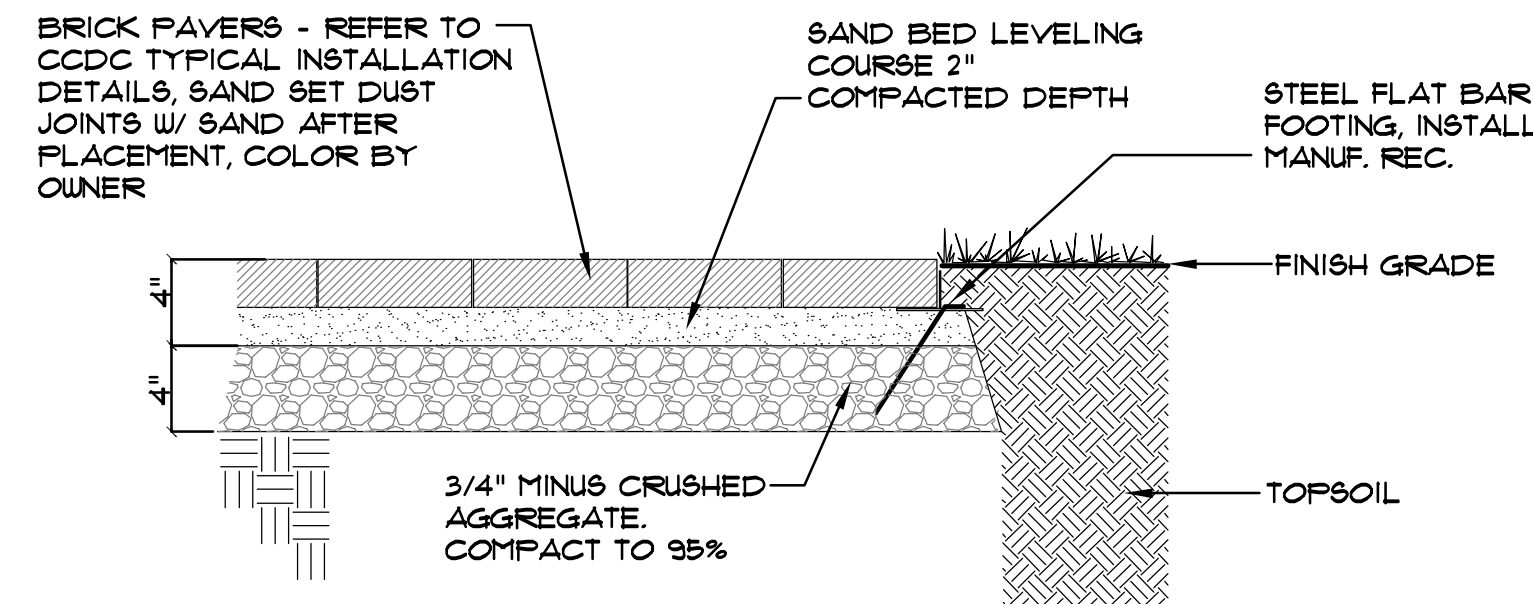

**erstad ARCHITECTS, PA**  
407 main street, suite 302, boise, idaho 83702  
(208) 331 9811 fax 331 9833 e-mail: erstad@erstadarch.com

This document is the property of erstad ARCHITECTS and is protected by U.S. and international laws. Use, reproduction or modification of this document without first obtaining the written permission of erstad ARCHITECTS is prohibited. This document may not be used in any unauthorized manner. ©2012

capitol + front st.  
300 s. capitol blvd.  
boise, idaho 83702

revision:

project: 120903  
date: 12.5.12  
drawn: JDR  
checked: TLS

design review

landscape plan

L1.0