

LANDSCAPE NOTES:

- Contractor shall verify all utility locations prior to construction operations.
- An automatic sprinkler system shall be installed for all landscaped areas. The system shall be designed and installed so as to prevent any overspray beyond the borders of the lot, particularly preventing overspray onto buildings, walkways and roads. Irrigation system shall provide 100% coverage.
- All lawn areas shall be irrigated with spray heads as required to fit the site. All shrub beds shall be irrigated with Netafim CV dripline. Install per manufacturers recommendations.
- All street trees shall be irrigated as defined in the CCDC Streetscape Standards.
- All lawn areas shall be irrigated separately of shrub and tree areas.
- Contractor shall zone sprinkler areas to best fit micro climates.
- Contractor shall submit an irrigation shop drawing to Landscape Architect for review prior to initiating landscape or irrigation installation.
- Report to Landscape Architect all conditions which prevent the proper execution of this work prior to beginning work.
- Contractor shall stake all trees necessary to prevent blow over. Contractor's discretion. Stakes must be removed within 12 months after planting.
- All plant material shall conform to the American Nurseryman standards.
- All planter beds shall receive a minimum 3" depth of small chunk bark mulch.
- All plant material shall be guaranteed for one year after installation. Contractor shall immediately replace all plant material found dead with the same size and species at no cost to the owner.
- Finish grades are to be smooth with positive drainage. See Grading Plan.
- The top 6" of topsoil in all planter beds and lawn areas are to be amended at a ratio of 3 cu. yds. of organic matter per 1000 sq. ft. Roto-till organic matter 6" into topsoil.
- Fertilize all trees and shrubs with 'Agriform' planting tablets. Follow manufacturer's recommendations.
- Ensure all planter beds have 18" of topsoil, lawn areas shall have a min. 12" of topsoil. Spread, compact and fine grade topsoil smoothly to 3" below surface of walkways and curbs in planter bed areas.
- Clean up any topsoil or other debris on site created from landscape operations and dispose of properly off site.

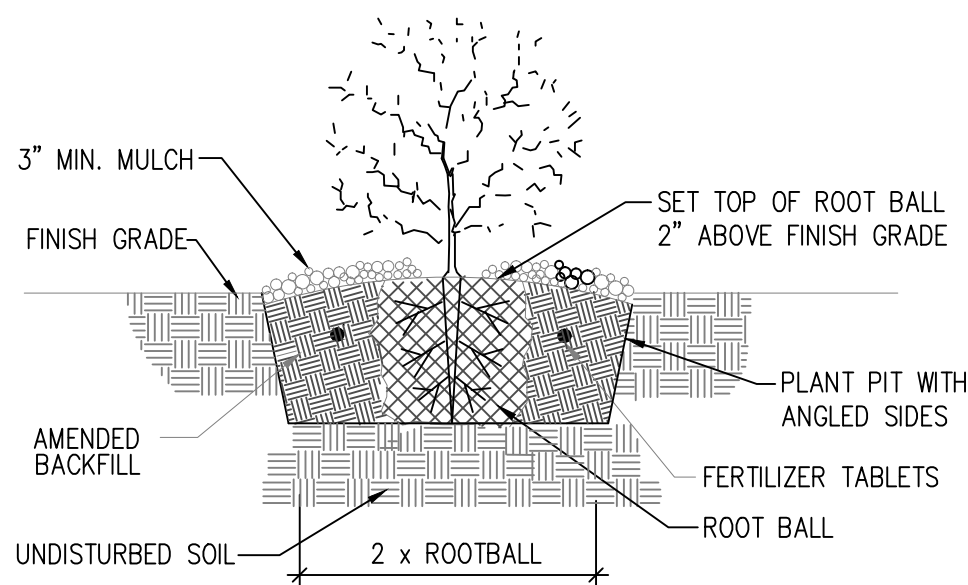

1 SHRUB PLANTING

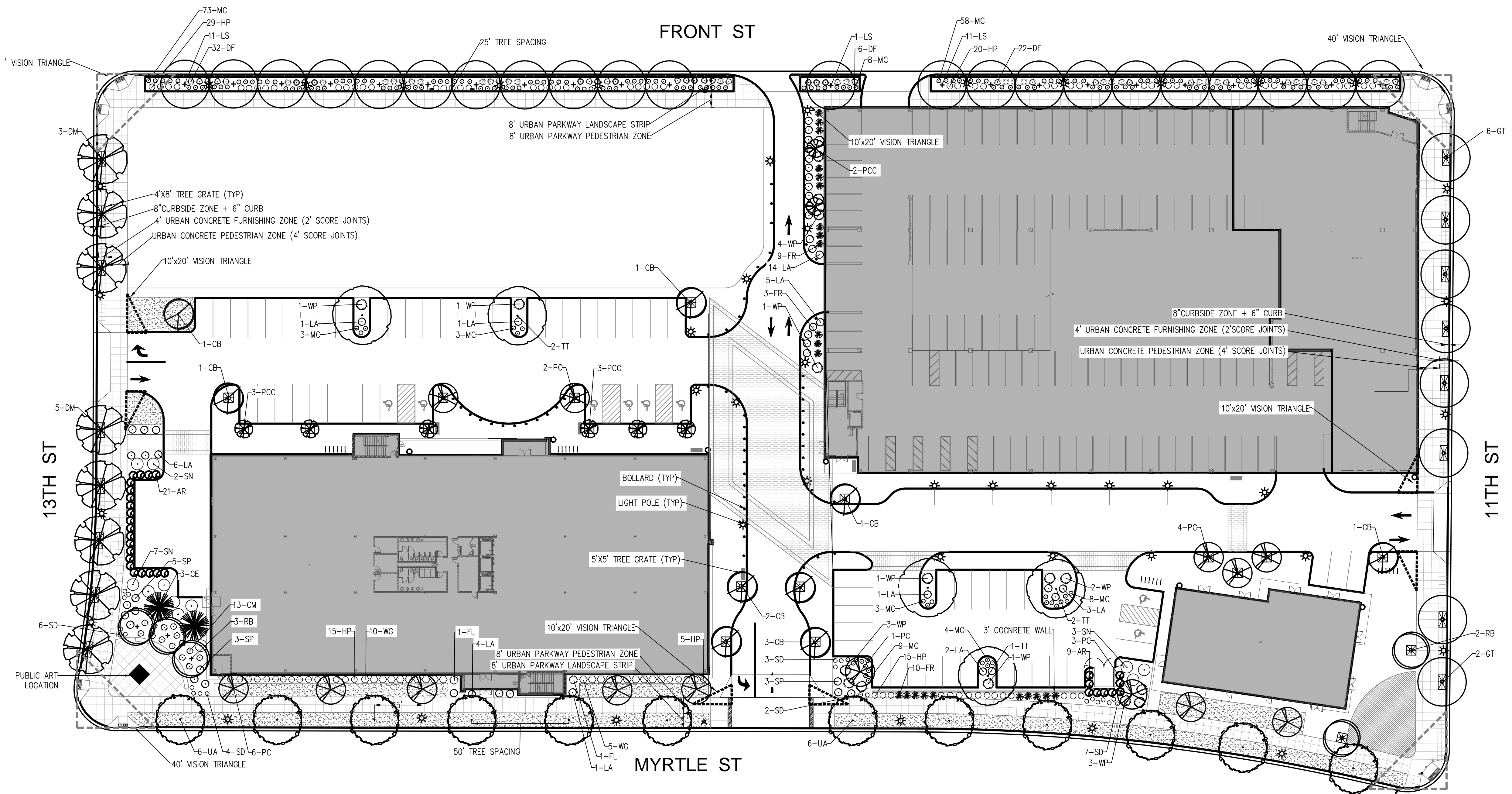
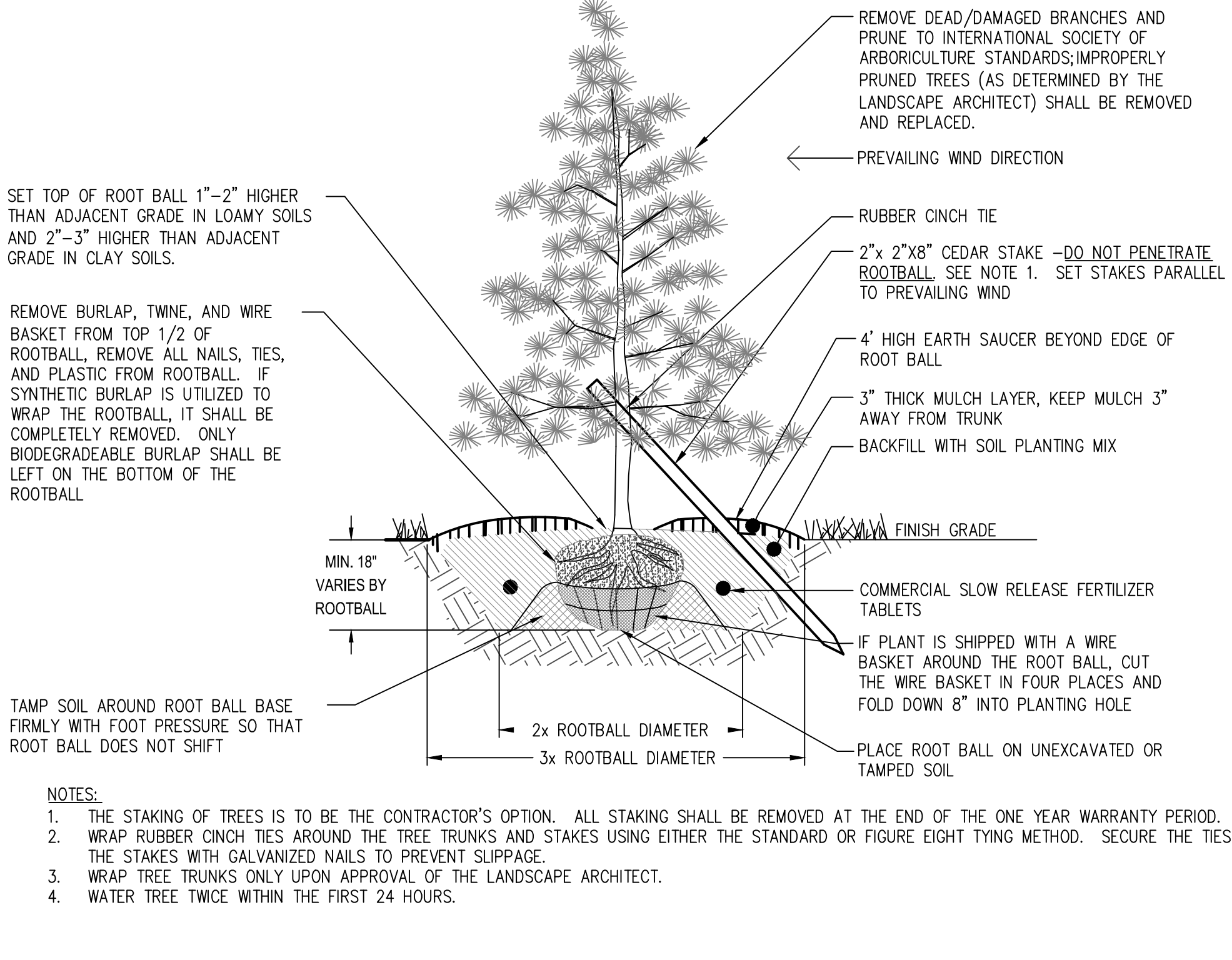
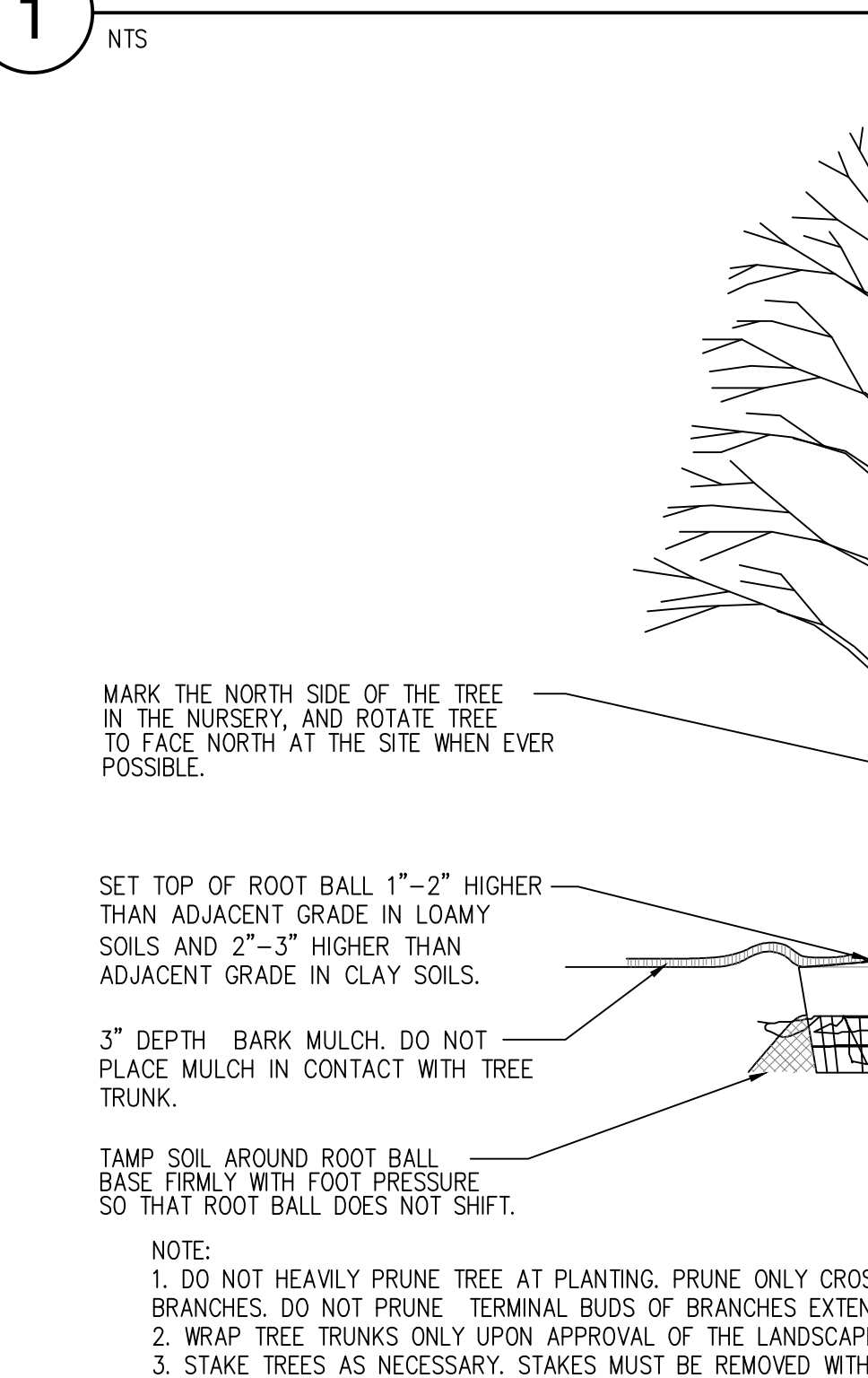

LEGEND	BOTANICAL NAME	COMMON NAME	SIZE	MATURE SIZE H x W	CLASS
ORNAMENTAL / FLOWERING TREES					
RB	<i>Cercis canadensis</i>	Eastern Redbud	2" CAL B&B	30' x 25'	I
PC	<i>Pyrus calleryana 'Glen's Form'</i>	Chanticleer Flowering Pear	2" CAL B&B	40' x 15'	I
PCC	<i>Prunus x cerasifera 'Cripzoizam'</i>	Crimson Pointe Flowering Plum	2" CAL B&B	20' x 6'	I
DECIDUOUS SHADE TREES					
CB	<i>Carpinus betulus 'Fastigiata'</i>	Columnar European Hornbeam	2" CAL B&B	35' x 15'	II
TT	<i>Liriodendron tulipifera 'JFS-Oz'</i>	Emerald City Tulip Tree	2" CAL B&B	55' x 25'	III
GT	<i>Tilia tomentosa 'Green Mountain'</i>	Green Mountain Linden	2" CAL B&B	40' x 25'	II
LS	<i>Liquidamber styraciflua 'Ward'</i>	Cherokee Sweetgum	2" CAL B&B	45' x 30'	II
DM	<i>Acer platanoides 'Deborah'</i>	Deborah Maple	2" CAL B&B	40' x 30'	II
UA	<i>Fraxus pennsylvanica 'Urbanite'</i>	Urbanite Ash	2" CAL B&B	50' x 40'	II
CONIFEROUS TREES					
CE	<i>Cedrus deodar 'Karl Fuchs'</i>	Karl Fuchs Himalayan Cedar	8-10" B&B	15' x 12'	
SHRUBS, PERENNIALS & GROUNDCOVERS					
AR	<i>Thuja plicata 'Daniellow'</i>	Golden Feather Arborvitae	5 GALLON	20' x 4'	
HP	<i>Berberis thunbergii 'Helmond Pillar'</i>	Helmond Pillar Barberry	2 GALLON	4' x 2'	
FR	<i>Calamagrostis x acutiflora 'Karl Foerster'</i>	Karl Foerster Feather Reed Grass	1 GALLON	4' x 2'	
MC	<i>Geranium sanguineum 'Max Frei'</i>	Max Frei Cranesbill	1 GALLON	1.5' x 2'	
SD	<i>Chrysanthemum x superbum 'Becky'</i>	Becky Shasta Daisy	1 GALLON	1.5' x 2'	
SN	<i>Physocarpus opulifolios 'Seaward'</i>	Summer Wine Ninebark	5 GALLON	5' x 5'	
LA	<i>Lavandula angustifolia 'Hidcote Blue'</i>	Hidcote Blue English Lavender	1 GALLON	2' x 3'	
SP	<i>Spirea japonica 'Yan'</i>	Double Play Gold Spirea	1 GALLON	2' x 3'	
DF	<i>Pennisetum alopecuroides 'Hameln'</i>	Dwarf Fountain Grass	1 GALLON	2' x 2'	
WP	<i>Pinus strobus 'Blue Shag'</i>	Blue Shag Easter White Pine	5 GALLON	4' x 5'	
FL	<i>Rhamnus frangula 'Ron Williams'</i>	Fine Line Fern Leaf Buckthorn	5 GALLON	8' x 3'	

LAWN (SOD)

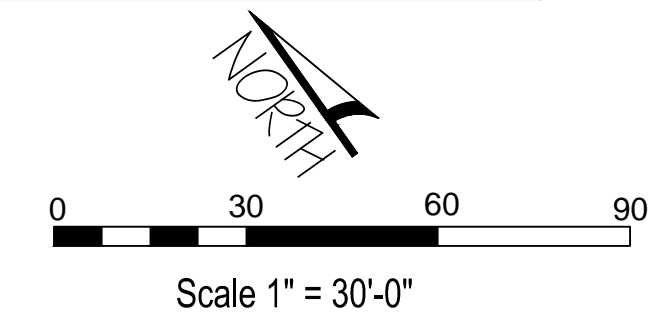

2 DECIDUOUS TREE PLANTING

NTS

3 CONIFER TREE PLANTING AND STAKING DETAIL

NTS

BAER DESIGN GROUP, LLC
 539 S. Fitness Place, Ste 120
 Eagle, ID 83616
 Ph. 208.938.7721

Boise, ID

Parcel 'B'

Landscape Plan

Revisions

Project No:	15038
Drawn by:	TB
Checked by:	GB
Date:	5.10.16

Sheet No: **L100**